

# *Prestige*

Windows and Doors



# ESWINDOWS

## Prestige products meet today's top architectural trends:

- Narrow sightlines
- Superior energy efficiency
- Hurricane resistance
- Custom colors
- Insulating glass and thermally broken aluminum
- Corrosion-resistant hardware for coastal applications



Design. Quality. Luxury.

The Prestige residential line is designed for sophistication and style. Each piece is carefully manufactured and checked for quality, ensuring full functionality and the ultimate end-user experience. These luxury windows and doors are built to the highest specifications to meet our exceptional standards.

*Prestige*



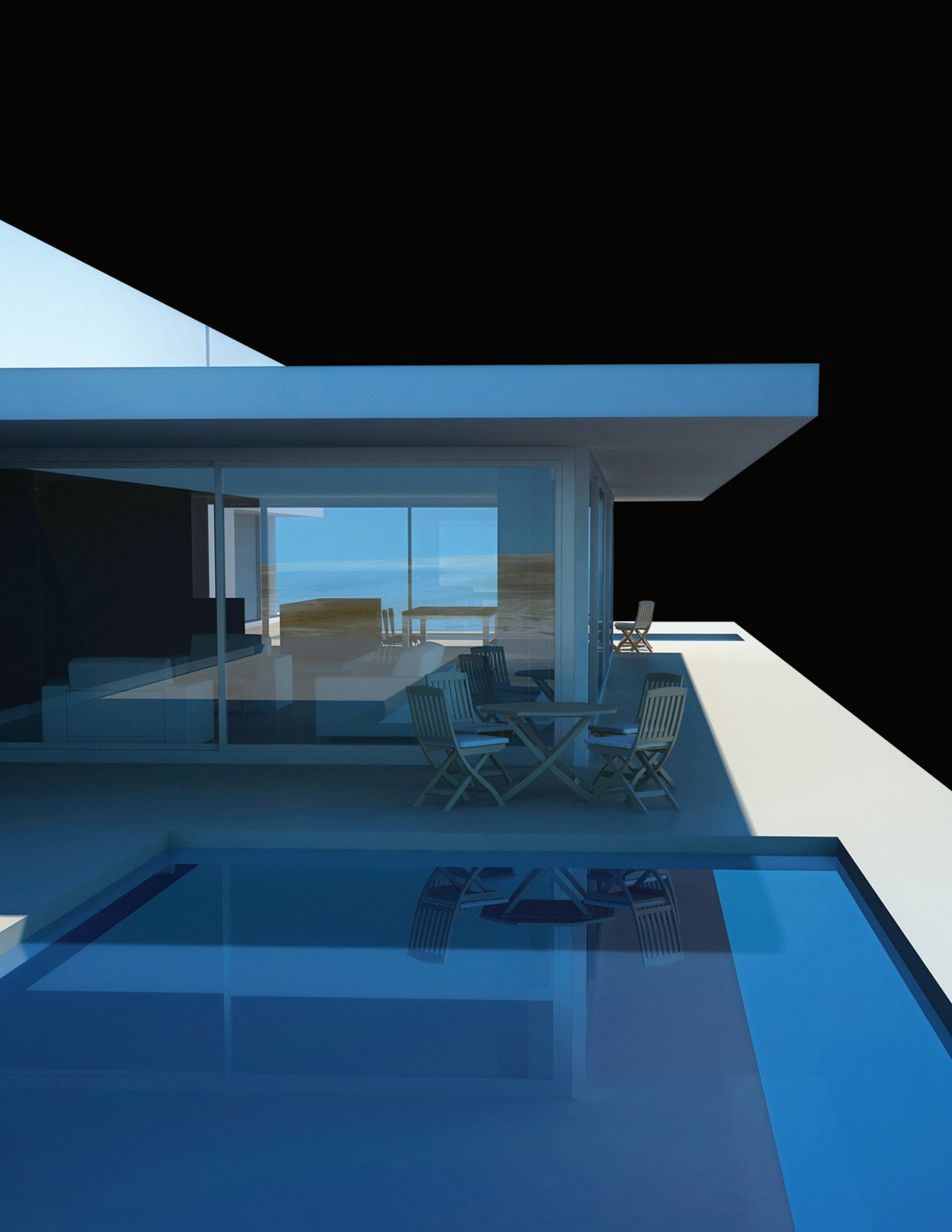

The Prestige collection was developed in collaboration with leading architects and designers who specialize in modern construction. The result: clean lines and large glass panels.

More than 30 years of experience as a window and door manufacturer have allowed us to develop this premier line of products that meet the highest performance standards. These products are crafted with one purpose: to bring the topmost quality and design to every project.

## Prestige Features

Consolidated under a single source warranty  
Available in two-tone finish  
High performance insulation from efficient spacers  
Superior energy performance with low U-values  
Reduced sound transmission  
Exclusive hardware  
Extended warranty  
Color or ultra-clear interlayers  
Coastal hardware standard

## Windows

**ES-P252 Casement/Awning/Fixed Window**  
**ES-FX2020 Fixed Window**  
**ES-SW340 Sliding Window**  
**ES-H340 Single Hung Window**  
**ES-FX3050 Frameless Window**  
**ES-8000T Jumbo Storefront Window**

## Doors

**ES-46T Swing Door**  
**ES-9000 Impact Door**  
**ES-SGD2020 Sliding Glass Door**  
**ES-SGD2040 ProSlide Door**  
**ES-BF5010T Bifold Door**

# WINDOWS

## ES-P252 Casement/Awning/Fixed Window

ES-P252 is an operable out-swing window that offers an unobstructed view and excellent ventilation. This product is ideal for areas that demand high light transmittance and minimal thermal transfer.

### System Description

#### Casement

Small and large missile impact rated  
Maximum size: 48" x 84"  
Frame depth: 2 1/2"  
Water infiltration: 17.1 psf.  
Design load: +95/-105 psf. (SMI), +95/-105 psf. (LMI)

#### Awning

Small and large missile impact rated  
Maximum size: 42" x 37"  
Frame depth: 2 1/2"

#### Fixed

Small and large missile impact rated  
Maximum size: 60" x 144"  
Frame depth: 2 1/2"  
Water infiltration: 17.1 psf.  
Design load: +95/-105 psf. (SMI), +95/-105 psf. (LMI)

### Features

Single arm operator and multi-point lock  
High performance stainless steel four bar hinge or butt hinges  
Head receptor, sub-sill and strap anchors available  
Thermally broken frame  
Flange or equal leg frame

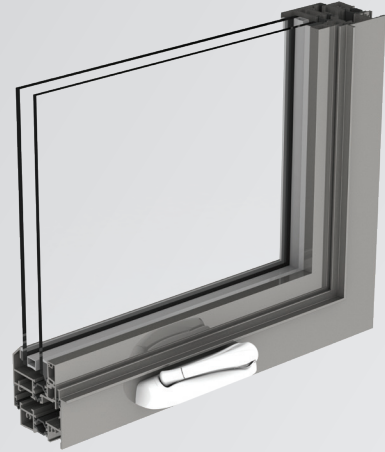

## ES-FX2020 Fixed Window

The ES-FX2020 fixed window is a narrow window wall that allows homeowners to achieve a consistent look across the façade next to the ES-SGD2020.

### System Description

Large missile impact rated  
Maximum size: 60" x 144" panels or 72" x 120" panels  
Frame depth: 6 7/16" (3 track), 8 1/2" (4 track)  
Water infiltration: 12 psf.  
Design load: +80/-80 psf.

### Features

Fixed window designed to match ES-SGD2020 sliding glass door  
Free standing jambs and self-mating mullions  
Multiple panel configurations  
Removable sill riser painted to match the door



# WINDOWS

## ES-SW340 Sliding Window

The ES-SW340 horizontal sliding window offers a wide window opening, while providing durability and maximum ventilation.

### System Description

Small and large missile impact rated

Maximum size:

OX / XO: 83 15/16" x 63" equal, 92 11/16" x 63" unequal

XOX: 126" x 63"

Frame depth: 3 3/8"

Water infiltration: 12 psf.

Design load: +80/-90 psf.

### Features

Polyamide rollers with stainless steel housing

Sweep lock

Thermally broken frame

Flange or equal leg frame





## ES-H340 Single Hung Window

The ES-H340 is a single hung window that operates vertically and is ideal for narrow spaces where accessibility and airflow are required.

### System Description

Small and large missile impact rated

Maximum size:

O/X: 54" x 78" / 43" x 96" equal, 39" x 81" unequal

Frame depth: 3 3/8"

Water infiltration: 12 psf.

Design load: +80/-90 psf.

### Features

Ultralift spiral balances

Snap and sweep lock

Thermally broken frame

Flange or equal leg frame

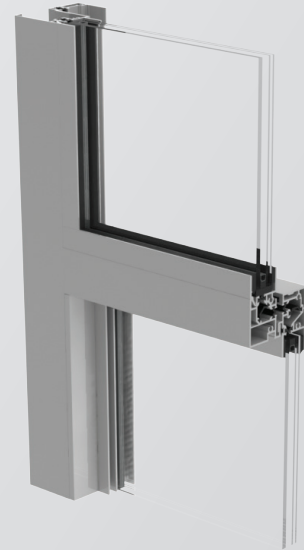

# WINDOWS

## ES-FX3050 Frameless Window

The ES-FX3050 frameless window is a glass wall that has no vertical aluminum profiles. The result is more glass and an unobstructed view.

### System Description

Large missile impact rated

Maximum size: 60" x 144"

Frame depth: 3 3/8"

Shoe height: 4 3/4"

Designed for 1 1/8" laminated glass

Water infiltration: 15 psf.

Design load: +100/-100 psf.

### Features

Top and bottom rail options

Multiple module option available

Corner option available

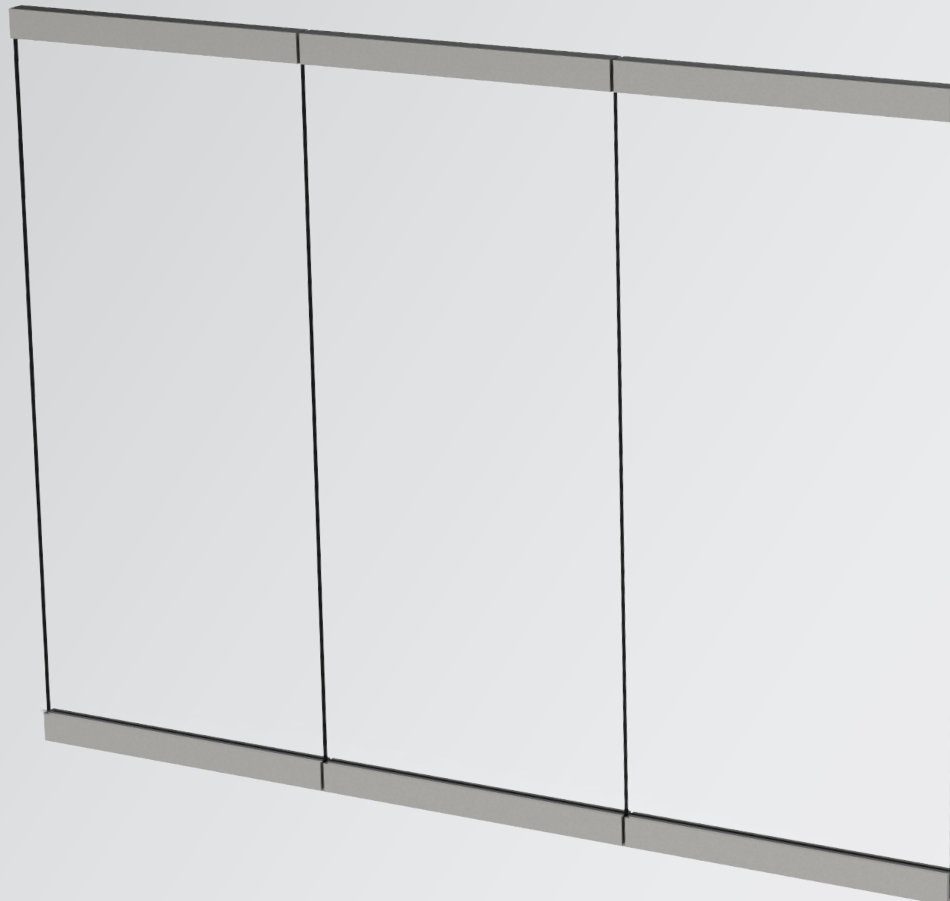
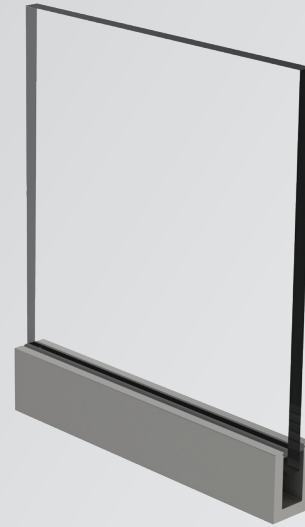

## ES-8000T Jumbo Storefront Window

The ES-8000T Jumbo is an impact resistant, thermal storefront system. This product is isolated with pour and debridge for a superior thermal performance. The ES-8000T Jumbo storefront system is compatible with the ES-9000 impact door.

### System Description

Large missile impact rated  
Maximum size: 84" x 180" in a single frame  
Frame depth: 5"  
Designed for insulating glass  
Water infiltration: 13.5 psf.  
Design load: +90/-120 psf.

### Features

Screw cover  
Integral door adaptor  
Pre-assembled and pre-glazed  
Surface applied ogee or flat muntins  
Thermally broken frame

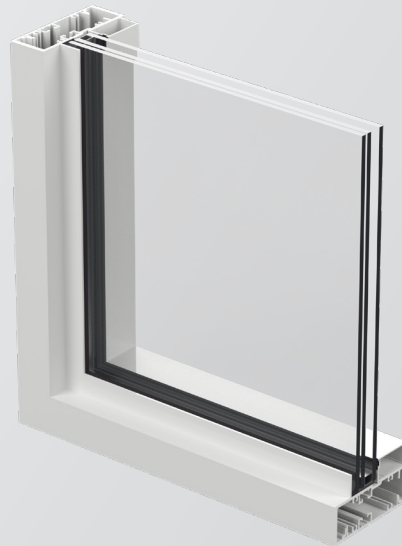

# DOORS



## ES-46T Swing Door

ES-46T is an out-swing door designed for balconies and open spaces. It pairs easy operation with a sophisticated modern look.

### System Description

Small and large missile impact rated

Maximum size for:

Single door: 41 3/16" x 108"

Single door with transom: 41 3/16" x 134"

Double door with sidelites: 160" x 98"

Double door: 80" x 120"

Double door with transom: 80" x 134"

Frame depth: 4 1/2"

Standard threshold height: 2 1/4"

ADA threshold height: 1/2"

Water infiltration: 15 psf.

Design load: +100/-120 psf.

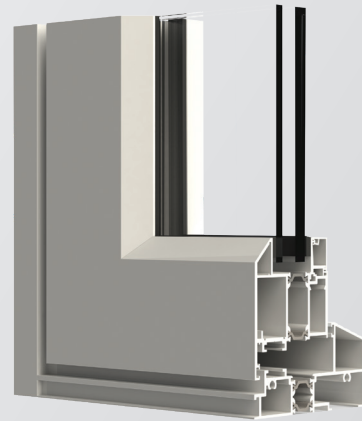

### Features

ADA threshold and high bottom rail optional

Multi-point hardware

Thermally broken frame



# DOORS

## ES-9000 Impact Door

ES-9000 Entry Door is an impact rated door functional as both outswing and inswing. Its profiles allow maximum sizes with modern lines that make it ideal for entrances.

### System Description

Maximum size for single door: 53" x 120"

Maximum size for double door: 101" x 120"

Available at 144" with transoms

Frame depth: 5"

Sight line: 1 3/4" or 2 1/2"

Designed for 9/16" laminated and 1 1/16" insulating laminated glass

Water infiltration: 18 psf.

Design load: +120/-120 psf.

Available in 3 point lock hardware and ladder pulls

### Features

Pre-assembled door leaf

Outswing or inswing

Blast rated

Concealed closer available

Snap on storefront-sidelite available

Stainless steel hardware

High and ADA thresholds

Corners are reinforced with welded aluminum brackets



Sophistication and style



*Prestige*

# DOORS

## ES-SGD2020 Sliding Glass Door

The ES-SGD2020 is an impact-rated sliding glass door with minimal sightlines. This narrow door features less aluminum and more glass than others allowing a clearer view.

### System Description

Large missile impact rated

Maximum size: 72" x 120" and 60" x 144" available in 2, 3, 4 and 5 tracks

Frame depth: 4 3/8" (2 track), 6 7/16" (3 track), 8 1/2" (4 track), 10 9/16" (5 track)

Sill height: 1 7/8"

90 degree and 135 degree corners

2" interlocks

Water infiltration: 12 psf.

Design load: +65/-65 psf.

### Features

Multiple panel configurations

Removable sill riser painted to match the door

Needle bearing acetal roller

Standard contemporary handle & thumb turn

2 point locking hardware

Multiple track options

Pocket configuration





## ES-SGD2040 ProSlide Door

The ES-SGD2040 ProSlide sliding glass door uses exclusive hardware designed for maximum protection and ease of operation. Our low-rise threshold provides easy accessibility while meeting hurricane standards for water intrusion resistance.

### System Description

Large missile impact rated  
Maximum size: 72" x 120" panels  
Frame depth: 6 1/2"  
Configurations: OX, XO, OXO, XOX, OXXO  
Sill height: 1 5/16"  
Water infiltration: 6.24 psf.  
Design load: +80/-80 psf.

### Features

Exclusive wrap around hardware  
Standard low sill option  
Balances ADA accessibility and water intrusion protection  
Effortless operation

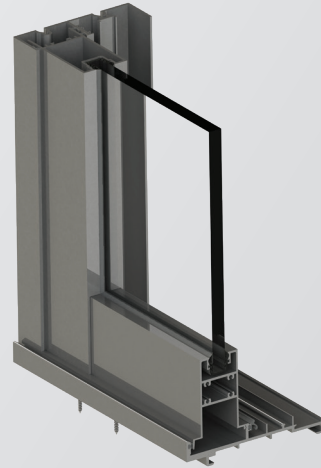

## ES-BF5010T Bifold Door

The ES-BF5010T bifold door allows you to join two spaces effortlessly. The system provides a completely clear opening with a maximum of 120" in height.

### System Description

Multiple 42" x 120" panels

Maximum 16 panels center meet

Frame depth: 5"

Threshold height: 2 1/2"

Designed for insulating laminated and laminated glass

2" threshold for maximum water infiltration protection

Water infiltration: 15 psf.

Design load: +95/-95 psf.

### Features

Thermally broken frames

ADA sill option



The perfect combination to expand  
and connect spaces

*Prestige*

# COLORS AND FINISHES

## Standard Colors

### *Duranar*



Sunstorm Silverstorm  
UC106685F



Sunstorm Arcadia Silver  
UC70123F

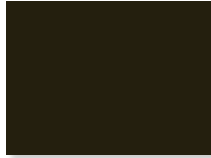

Bermuda Bronze  
UC105262

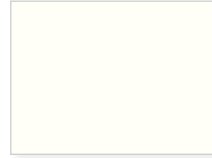

Bone White  
UC43350



Black  
UC40577

### *Woodgrain*

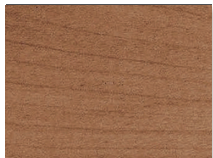

Embero  
DS 739 2301/02L



Nogal  
DS 750 1807/01L



Sapely  
DS 750 2505/01L

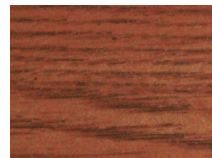

Teka  
DS 733 2601/01L

### *Hardware Finishes*



Silver



Antique Brass

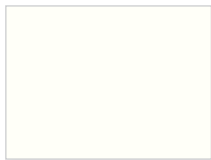

White



Black



Bronze



Brushed Chrome

- Personalized colors and hardware finishes available
- Class 1 clear anodized finish is available upon request

# ACCESORIE

## Design elements

The Prestige line pairs fine architectural details with uncompromising performance.

Every Prestige window and door is produced with the finest materials, using the latest technologies and benefiting from the skilled talent of our experienced team. The result is an aesthetic design with engineered precision and proven performance.



*ES-P252*



*ES-46T*



*ES-SGD2020*



*ES-SGD2040*



*ES-BF5010T*

# EXPERTISE

## **Engineering and Design**

We specialize in providing solutions for the most complex projects and responding efficiently to the requests of architects and developers. The combination of advanced software technology and a team of engineers and designers who specialize in aluminum, glass, window systems and façades, allow us to ensure delivery of high quality products that meet our customers' needs.

The Prestige line provides the perfect combination of luxury, design and performance across a wide range of product types. Whether you are looking for noise reduction, temperature control, or protection from extreme weather, our line of products can provide the perfect solution, without sacrificing aesthetics.

## **Service**

Our engineers and designers provide ongoing assistance and technical support to ensure the best solution for each type of project. We offer each customer complete and personalized guidance, pointing out the main factors to consider in order to plan and carry out their construction with maximum benefits.



*Prestige*

Design. Quality. Luxury.

**ESWINDOWS**  
The Power of Quality

*Prestige*